

**NOTES:**

1. 3" X 2" X 1/4" RECT. ALUMINUM TUBING CROSS SILLS.
2. 3" X 2" X 1/4" ALUMINUM CHANNEL CROSS SILLS.
3. 3" X 3" X 1/4" SQUARE ALUMINUM TUBING LONG SILLS.
4. 3/4" WOOD SPACER.
5. CHASSIS: FORD, DODGE OR GM DRW 84" C.A. (NOM), FRAME WIDTH 34"(NOM.).
6. COMPARTMENTS FABRICATED FROM 1/8" ALUMINUM, STITCH WELDED INSIDE AND OUT.
7. PAINT CODE: TBA.
8. STANDARD WORKLIGHT DOOR BRACKET INSTALLED ON EACH DOOR (EXCEPT IN OXY/ACET. COMPARTMENT).

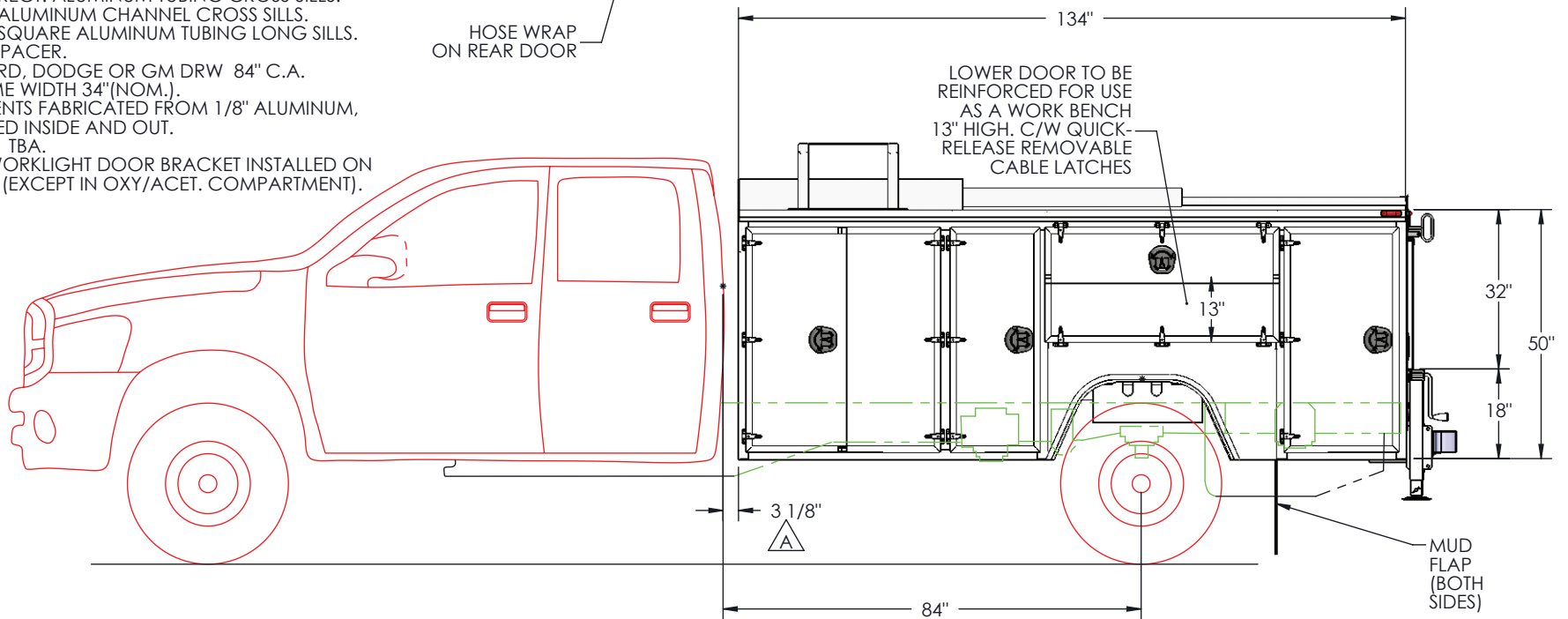

Customer:	<b>GENERAL BODY &amp; EQUIPMENT LTD.</b>		A	MAR. 23, 2010	C.M.	REVISED SPACE BETWEEN CAB & BODY TO 3.1"	
Date:	DEC. 31, 2008	Scale:	1:34	REV.	DATE	BY	DESCRIPTION
Drawn By:	N. MACDONALD	Ck. By:	C. MAILLET	Page#:	1 of 9	CAD File:	1872TS00

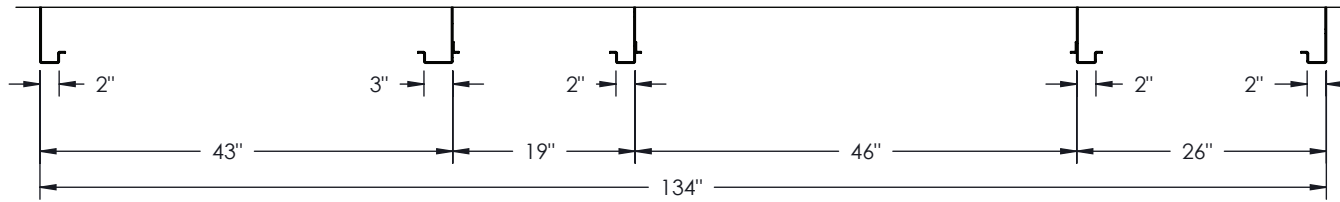

SECTION A-A

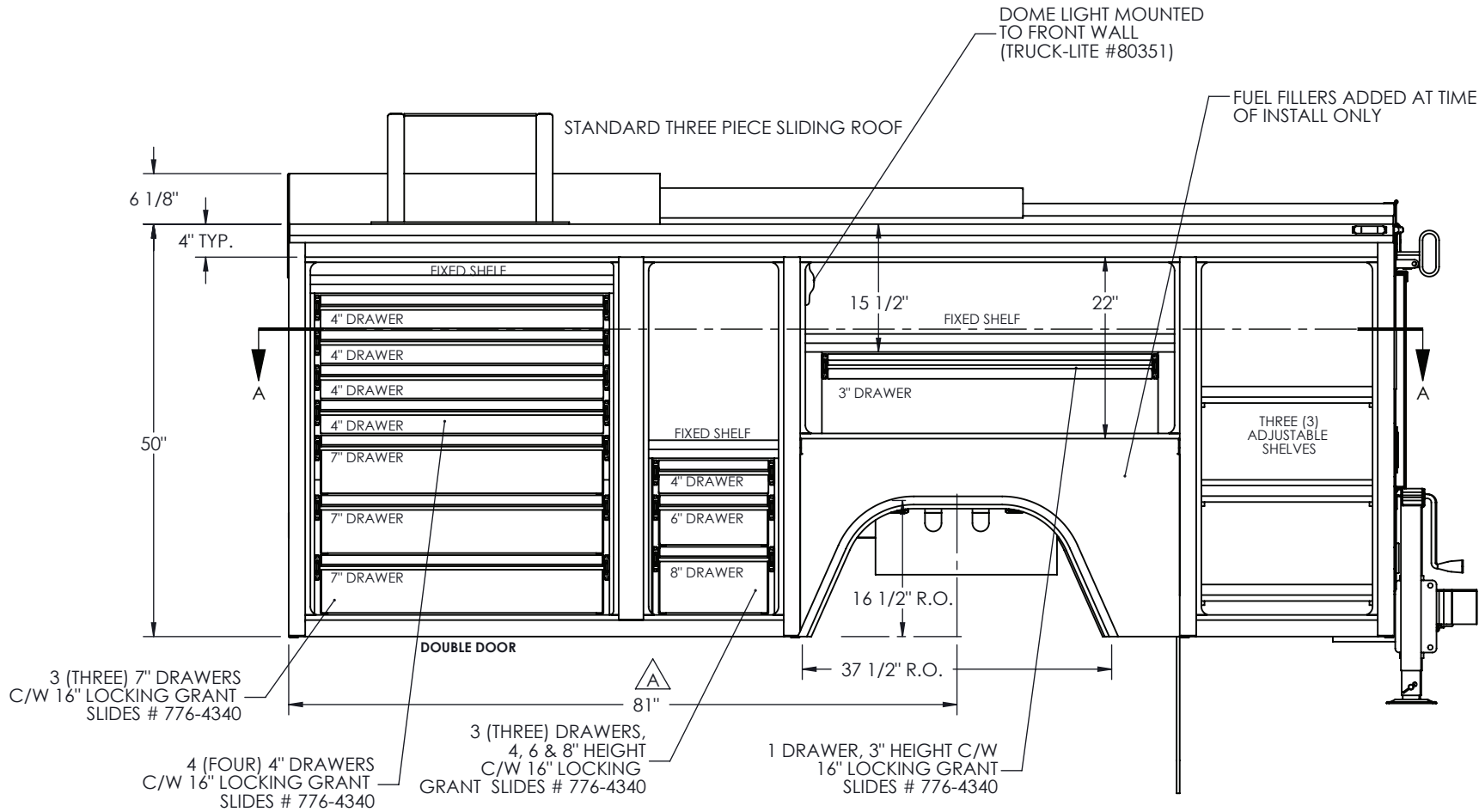

ROAD SIDE VIEW

- NOTES:
1. BODY MUST BE MOUNTED 3" CLEAR FROM BACK OF CAB
  2. TRUCK FRAME WIDTH IS 34" NOM.
  3. HORIZONTAL DOORS ARE LINED C/W QUICK-RELEASE CABLE LATCHES

A	MAR. 23, 2010	C.M.	REVISED WHEEL WELL CUTOUT LOCATION
REV.	DATE	BY	DESCRIPTION
Ck. By:	Page#:	CAD File:	
C. MAILLET	2 of 9	1872TS00	



Customer: **GENERAL BODY & EQUIPMENT LTD.**

Date: DEC. 31, 2008

Scale: 1:20

Drawn By: N. MACDONALD

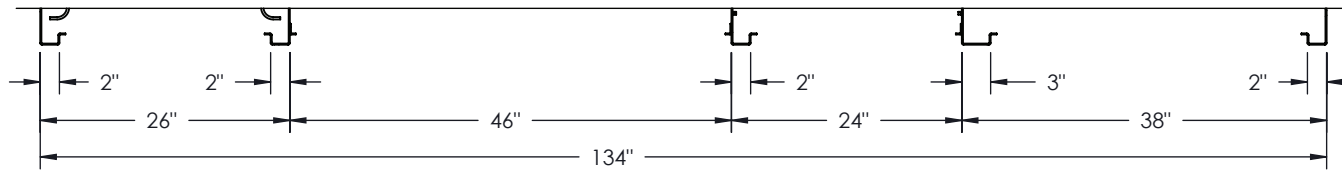

SECTION B-B

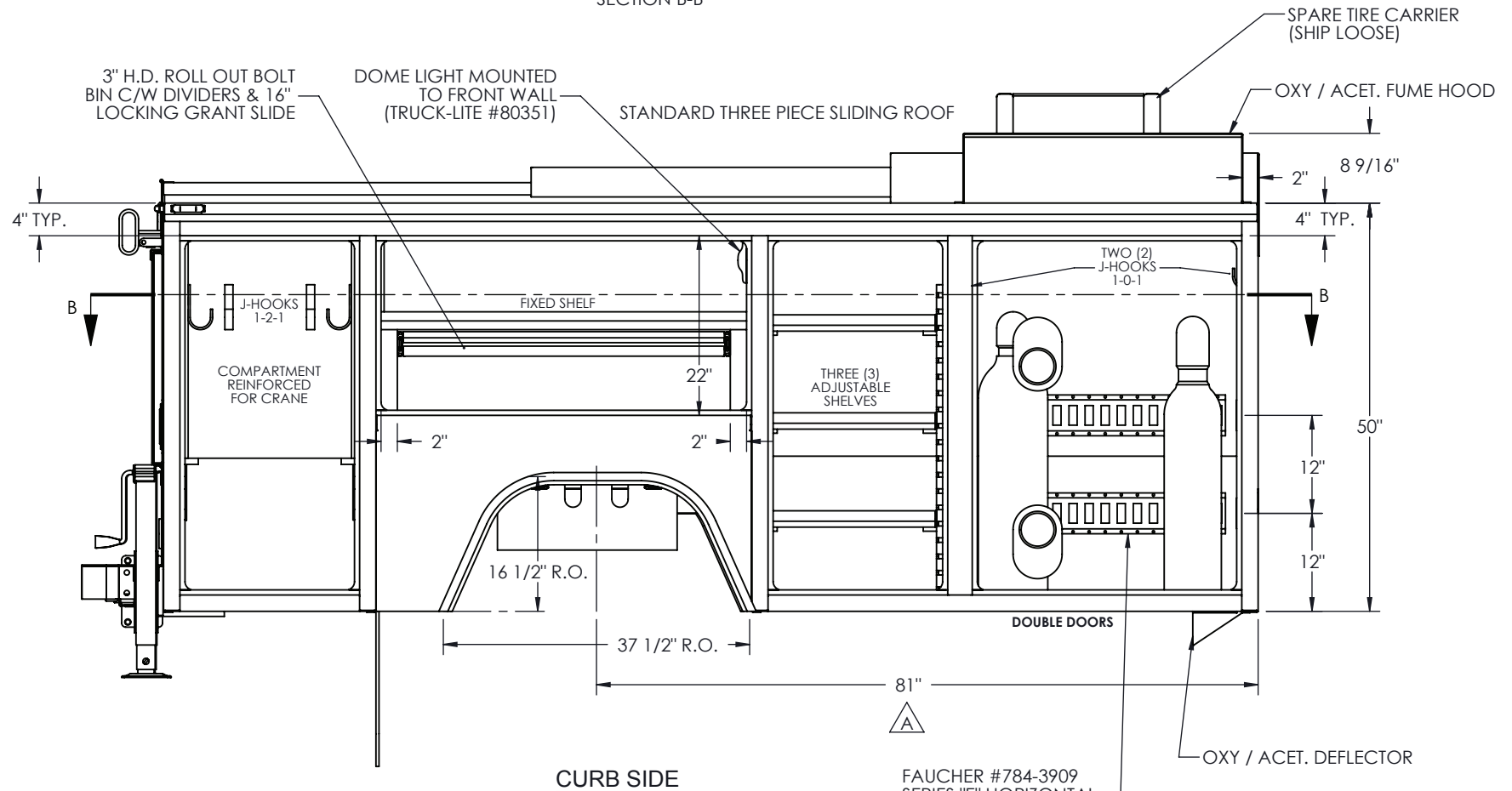

CURB SIDE

FAUCHER #784-3909  
SERIES "E" HORIZONTAL  
TRACKS ON 3 WALLS

- NOTE:
1. BODY MUST BE MOUNTED 3" CLEAR FROM BACK OF CAB
  2. TRUCK FRAME WIDTH 34" NOM.
  3. HORIZONTAL DOORS ARE LINED & WITH QUICK-RELEASE CABLE LATCHES

A	MAR. 23, 2010	C.M.	REVISED WHEEL WELL CUTOUT LOCATION
REV.	DATE	BY	DESCRIPTION
Ck. By:	Page#:	CAD File:	
C. MAILLET	3 of 9	1872TS00	



Customer: GENERAL BODY & EQUIPMENT LTD.

Date: DEC. 31, 2008

Scale: 1:20

Drawn By: N. MACDONALD

Ck. By: C. MAILLET

Page#: 3 of 9

CAD File: 1872TS00

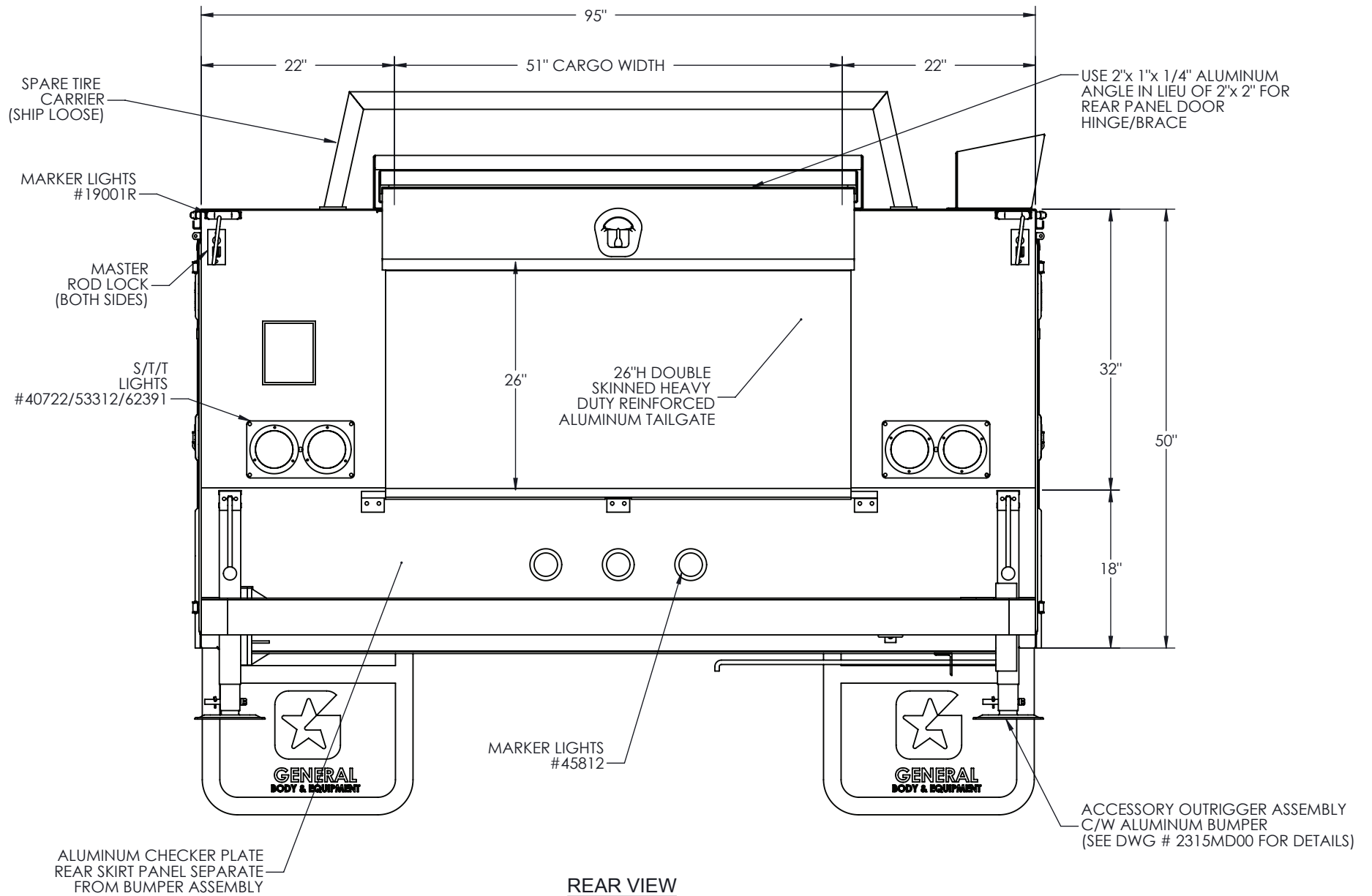

**GENERAL BODY & EQUIPMENT**

Customer: <b>GENERAL BODY &amp; EQUIPMENT LTD.</b>	REV.	DATE	BY	DESCRIPTION
Date: DEC. 31, 2008	Scale: 1:16	Drawn By: N. MACDONALD	Ck. By: C. MAILLET	Page#: 4 of 9 CAD File: 1872TS00

NOTE:  
 DO NOT DRILL HOLES IN BODY FOR:  
 1 - BOOM REST  
 2 - SPARE TIRE CARRIER  
 3 - CRANE MOUNTING HOLES

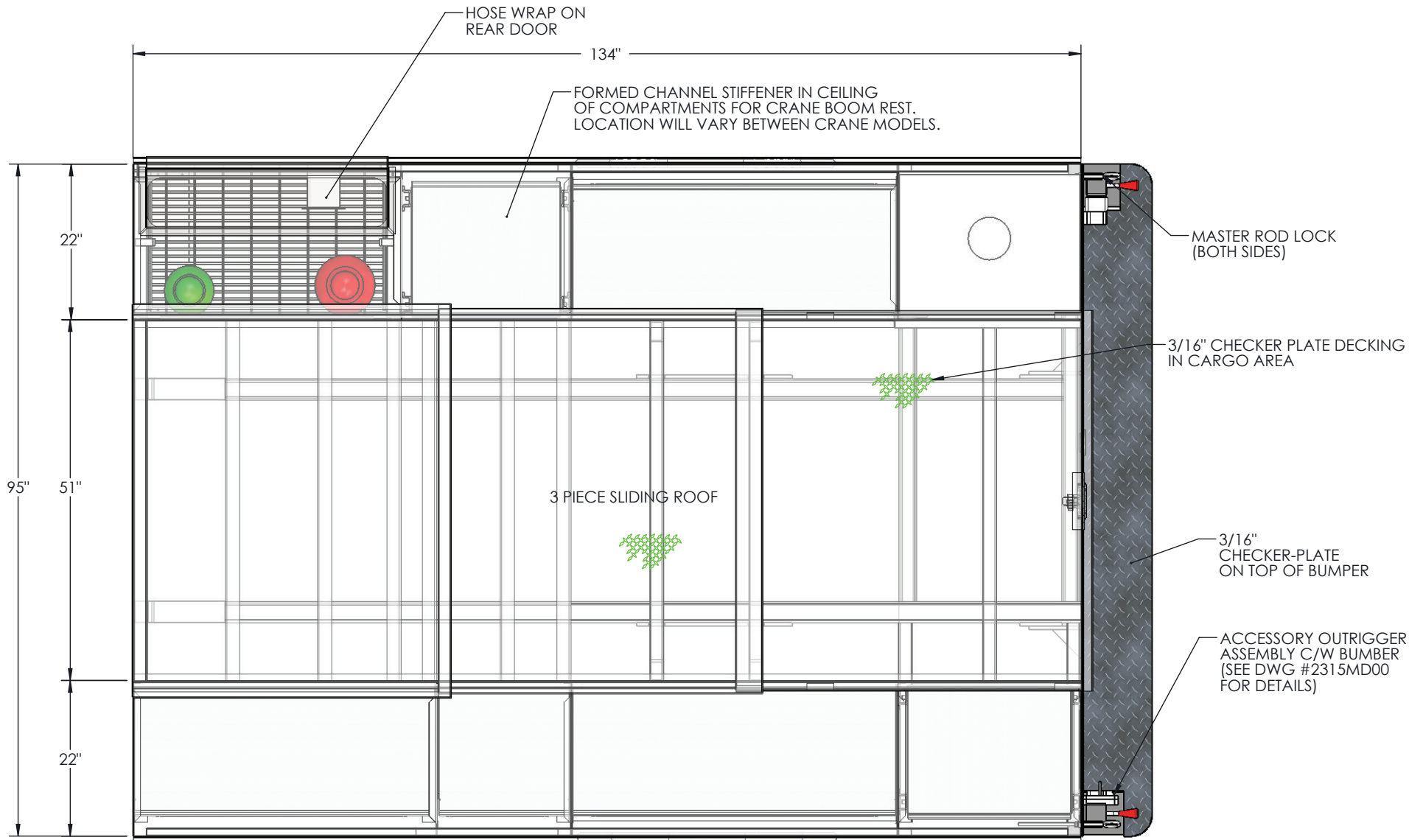

PLAN VIEW



**GENERAL BODY & EQUIPMENT**

Customer: **GENERAL BODY & EQUIPMENT LTD.**

REV.

DATE

BY

DESCRIPTION

Date: DEC. 31, 2008

Scale: 1:20

Drawn By: N. MACDONALD

Ck. By: C. MAILLET

Page#: 5 of 9

CAD File: 1872TS00